

PRODUCT  
BROCHURE



JUMBO

SMART | SUSTAINABLE | SAFE  
FIBRE CEMENT BOARD

# HIGH THICKNESS

## FIBRE CEMENT BOARD

Welcome to the future of construction and design with our High Thickness Fibre Cement Boards. Crafted to meet the demands of modern architecture, these boards redefine the possibilities of strength, durability, and versatility in your projects.





## Jumbo Boards

Build to Last,  
Designed to Excel!

**Jumbo's High Thickness Fibre Cement Boards** are a versatile and durable solution for a wide range of construction and interior applications. Designed to offer exceptional strength and stability, these boards are resistant to fire, termites, and moisture, ensuring long-lasting performance. Their sound-absorbent and energy-efficient properties enhance comfort while reducing maintenance costs.

Ideal for various spaces such as homes, offices, schools, hospitals, malls, and commercial buildings, these boards provide a reliable, easy-to-install, and eco-friendly alternative to traditional materials like plywood. Jumbo's High Thickness Fibre Cement Boards are crafted to meet the highest standards of safety, durability, and aesthetics, making them a preferred choice for modern construction needs.

## Dimensions

**Size:** 8 feet × 4 feet

**Thickness:** 6mm,  
8mm, 10mm, 12mm,  
16mm, 18mm

# HIGH THICKNESS FIBRE CEMENT BOARD

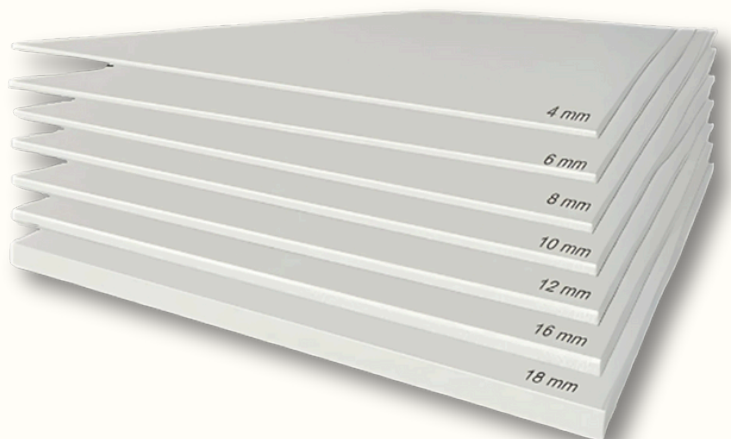
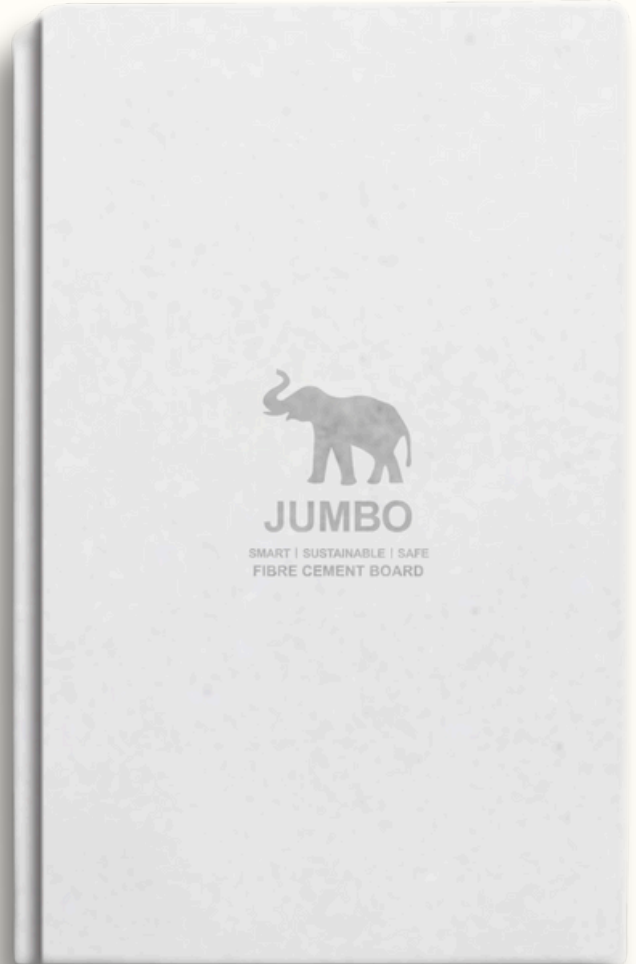

# HIGH THICKNESS FIBRE CEMENT BOARD

## Key Features

Key Features	Jumbo board	Plaster board	Plywood
Heat Resistant	★★★★★	★★	★
Fire Retardant	★★★★★	★	★
Moisture Resistant	★★★★★	★	★
Termite Proof	★★★★★	★★	★★
Noise Insulation	★★★★★	★★★	★★★★
Workability	★★★★★	★★	★★
Non Corrosive	★★★★★	★★★	★★
Long Lasting	★★★★★	★★	★★

## Technical Properties

Properties	Unit	Standard	Requirement	Values
Across Strength	Kg	IS-14862	-	18
Parallel Strength	Kg	IS-14862	-	12
Modulus of Rupture (MOR)	N/mm <sup>2</sup>	IS-14862	7.0 (Min)	10.5
Density (Dry)	Kg/m <sup>3</sup>	IS-14862	1100 (Min)	1200
Moisture Content	%		-	6 to 8

# HIGH THICKNESS FIBRE CEMENT BOARD

## Usage

- Partition
- Cladding
- Flooring
- Facade
- Roof Underlay
- Panelling
- Kitchen Counters
- Doors
- Staircases
- Walls

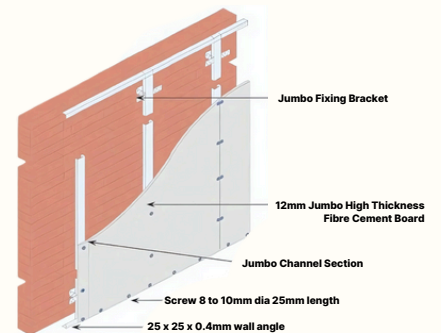
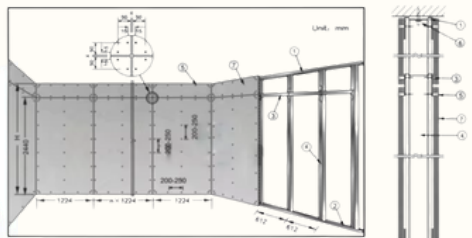
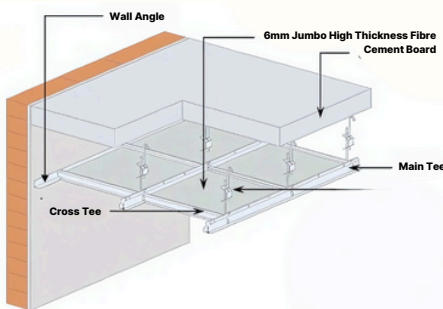
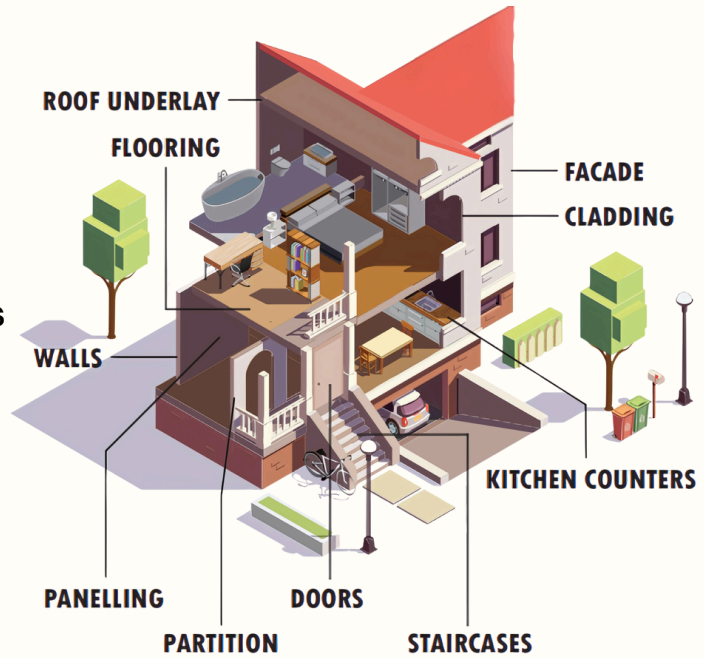

# Contact Us

 +91 73990 94304

 [jumboboards.com](http://jumboboards.com)

 [jumborooft@gmail.com](mailto:jumborooft@gmail.com)

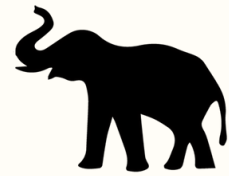

**JUMBO**

SMART | SUSTAINABLE | SAFE  
FIBRE CEMENT BOARD

# JRT INDUSTRIES LLP

Premium Fibre Cement Board Manufacturer

Scan for



Product Catalogue

Follow Us On

 @JumboFibreCementBoard

 @jumbo\_fibre\_cement\_board

 @Jumbo\_Fibre\_Cement\_Board